



COUNTY OF MENDOCINO
Executive Office
Facilities & Fleet Division

CARMEL J. ANGELO
CHIEF EXECUTIVE OFFICER

851 Low Gap Road
Ukiah, CA 95482

Email: facilities@mendocinocounty.org
Website: www.mendocino-county.org

Office: (707) 234-6050
Fax: (707) 463-4673

ADDENDUM #: 1

PROJECT: BID 44-18 Ukiah Library Interior Painting Project

DATE: 12-14-2018

ISSUED BY: Doug Anderson

The additions, omissions, clarifications, and/or corrections herein shall be made part of the Contract plans and specifications and shall be included in the Scope of Work and proposals to be submitted. This Addendum modifies the original plans and specifications as described below.

INQUIRIES AND CLARIFICATIONS TO PROJECT PLANS AND SPECIFICATIONS

1. **Q:** Existing floor plan does not show the office inside the children's area. Does this area Paint?

A: Yes, See attached sheet SK1 showing approximate size and location of the children's librarian office. All wall surfaces inside and outside this office shall be painted. Stain wood door to match laminate door color.
2. **Q:** Painting Note 6 states to paint wood or metal door frames. Door frames appear to be laminate or bronzed aluminum. Do these door frames paint?

A: No, do not paint laminate or bronzed aluminum door frames. Paint wood frames and stops at children's librarian window.
3. **Q:** Are the vertical rainbow panels in the children's room light well to be painted?

A: No.
4. **Q:** Have colors been selected for this project? Will all walls be painted the same color?

A: Provide two colors for the walls. All walls below the 10' ceiling height shall be white to match the existing white in the teen room. The high east wall shall be brown to match the wood slats.

ADDITIONAL INFORMATION

See attached sheet SK1.
See attached pre bid attendance sheet.

Bidders are reminded that they shall complete the Addenda Acknowledgement in the Bid Form of their Specification Book (Section 00310-2). Failure to do so may result in disqualification of the submitted bid.

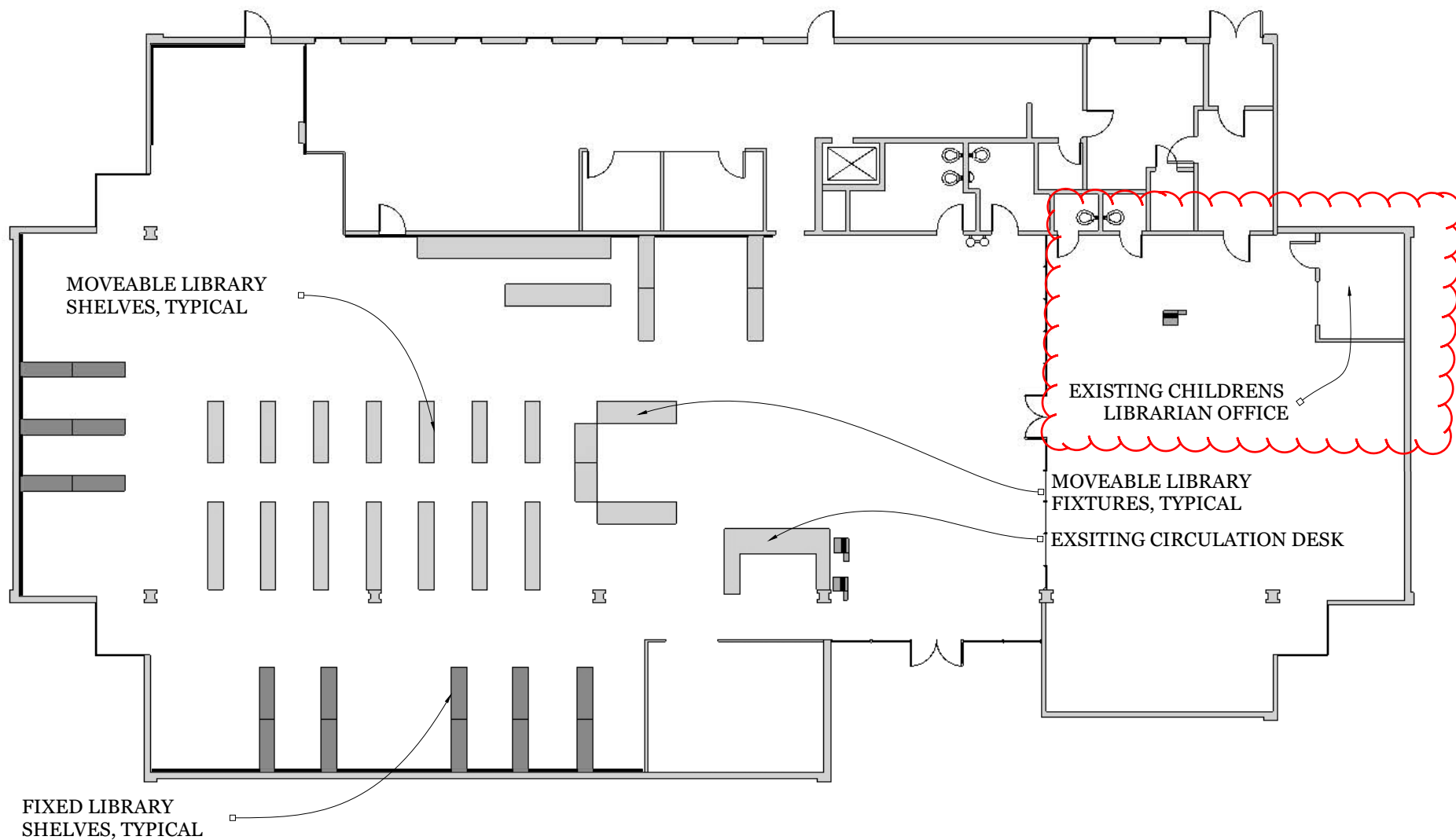

EXISTING FLOOR PLAN

