

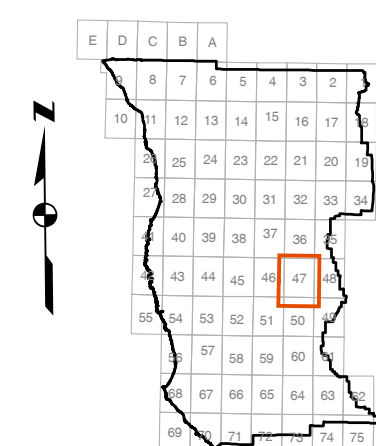

**REDWOOD VALLEY**  
USGS QUADRANGLE BASE



ZONING DISPLAY MAP



PRODUCED 2015  
MENDOCINO COUNTY  
PLANNING & BLDG. SVCS.  
**THIS IS NOT AN ADOPTED MAP**  
FOR DISPLAY PURPOSES ONLY  
Print Date: 7/6/2015

<b>AG</b>	Agricultural Lands
<b>AG-CR</b>	Agricultural (Contract Rezone)
<b>AV</b>	Airport District
<b>C</b>	Coastal Commercial
<b>C-PD</b>	Coastal Commercial (Planned Development)
<b>C1</b>	Inland Limited Commercial
<b>C1-CR</b>	Inland Limited Commercial (Contract Rezone)
<b>C2</b>	Inland General Commercial
<b>C2-CR</b>	Inland General Commercial (Contract Rezone)
<b>C2-IS</b>	Inland General Commercial (Isolated Service)
<b>FL</b>	Forestland
<b>FV</b>	Fishing Village
<b>I</b>	Coastal Industrial
<b>I2</b>	Inland Limited Industrial

- Ia-CR** Inland Limited Industrial (Contract Rezone)
- Iz** Inland General Industrial
- OS** Open Space
- OS-CR** Open Space (Contract Rezone)
- PI** Pinoleville Industrial
- PF** Public Facility
- PF-PD** Public Facility (Planned Development)
- RC** Rural Community
- RC-CR** Rural Community (Contract Rezone)
- RL** Rangeland
- RL-PD** Rangeland (Planned Development)
- SR** Suburban Residential
- TP** Timberland Production
- UR** Upland Residential

<b>UR-CR</b>	Upland Residential (Contract Rezone)
<b>UR-PD</b>	Upland Residential (Planned Development)
<b>SR</b>	Single Family Residential
<b>R2</b>	Two Family Residential
<b>R3</b>	Multi Family Residential
<b>RMR</b>	Remote Residential
<b>RMR-DL</b>	Remote Residential (Development Limitation)
<b>RR</b>	Remote Residential (Planned Development)
<b>RR</b>	Rural Residential
<b>RR-CR</b>	Rural Residential (Contract Rezone)
<b>RR-DL</b>	Rural Residential (Development Limitation)
<b>RR-PD</b>	Rural Residential (Planned Development)
<b>RR-PD-DL</b>	Rural Residential (Planned Development Limitation)
<b>RV</b>	Rural Village

MC Mendocino Commercial  
MFL Mendocino Forestland  
MMU Mendocino Mixed-Use  
MOS Mendocino Open Space  
MPF Mendocino Public Facility  
MRM Mendocino Multi-Family Residential  
MRR Mendocino Rural Residential  
MSR Mendocino Suburban Residential  
MTR Mendocino Town Residential  
GPD Gualala Planned Development  
GVMU Gualala Village Mixed Use  
GHMU Gualala Highway Mixed Use  
GI Gualala Industrial  
RR, [RR] Variable Density Zone (see note below)

Zoning designations shown in [brackets] (coastal zone only) indicate 'variable density zones'. Per county code Sec. 3.8-10 in order to be developed to the smaller parcel size, areas indicated on the map as having a variable density zoning classification shall be required to be served by a public water system which utilizes surface waters, and which does not impact upon the ground water resource, or by completion of a hydrological study which supports those greater densities.