

PROJECTS

1. STRAIN ALL EXPOSED EARTH AREAS EXCEPT FOR WORKING AREAS AND INTERCEPT TRENCH
2. INSTALL 3 BAFLE SYSTEMS
3. REPAIR SLIDE -
 - a. REMOVE ALL TREES KILLED DUE TO SLIDE ACTIVITY
 - b. PLACE LOGS, WOOD, TREES, ETC. PARALLEL TO STREAM AT JOE OF EXISTING SLOPE
 - c. SAND BAG USING SLIDE MATERIAL INSTREAM, ABOVE LOGS
 - d. PLACE MESH OVER ENTIRE SLIDE AREA
 - e. DIVERT SILLER ACROSS ABOVE SLIDE
4. MODIFICATION OF INLET AND OUTLET (SUMMER WORK)
5. INSTALL FILTER AROUND END OF INLET PIPE (SEE DO) AND CMP INLET
6. INSTALL MESH OVER OLD SLIDE AREA

INSTALL GRAVEL SEDIMENT BASINS DOWNSTREAM ENTRANCE PRIOR TO ANY AND ALL WORK.

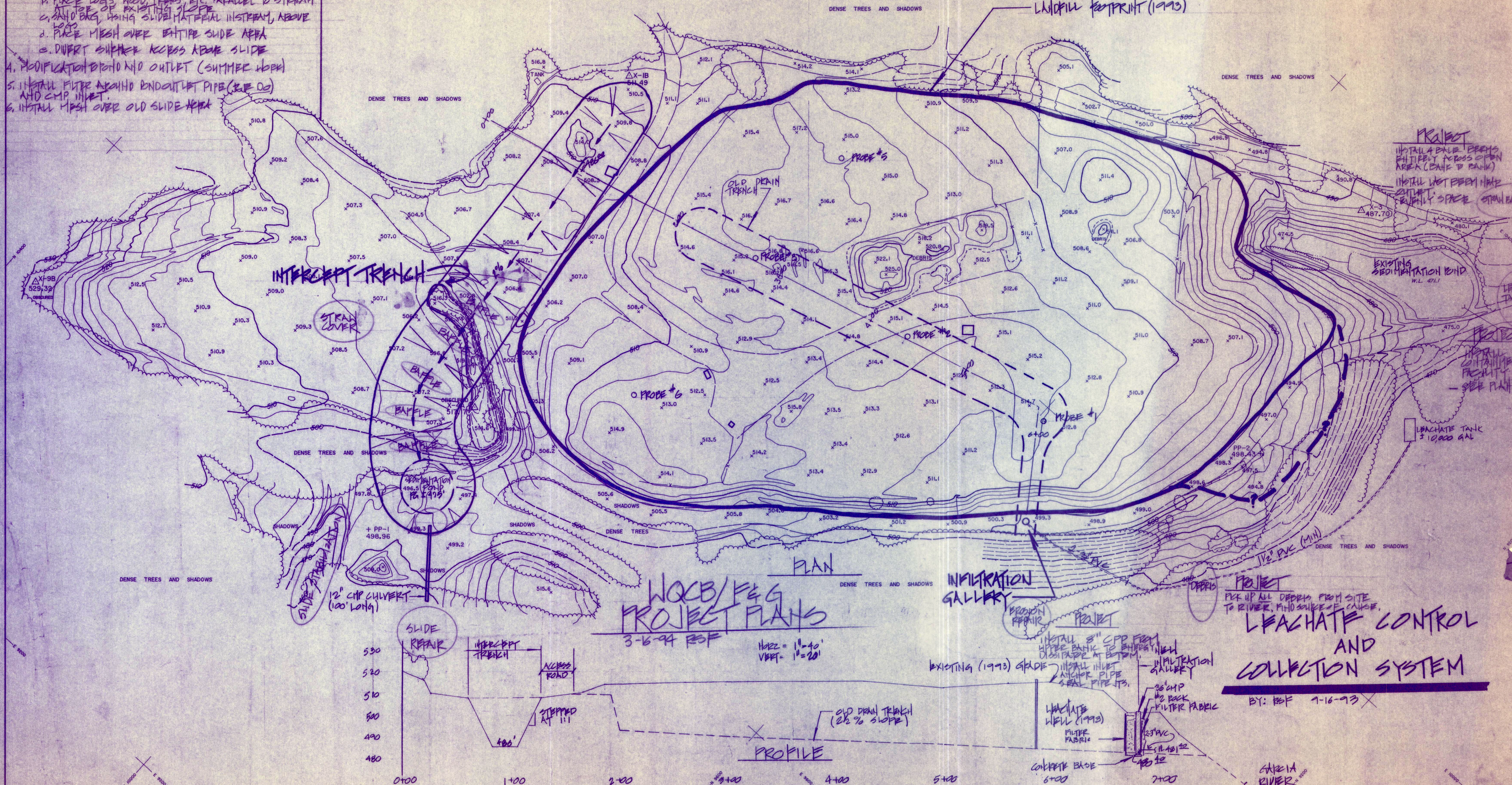

**AERIAL PHOTOGRAPHY
TOPOGRAPHIC MAPPING**
2777 CLEVELAND AVE., STE. 115
SANTA ROSA, CALIFORNIA 95403
(707) 546-0458 FAX (707) 546-0462

MAP SCALE:	1"=40'	PHOTO SCALE:	1"=240' ±
CONTOUR INTERVAL:	2 FEET	PHOTO DATE:	6-11-93
JOB NUMBER:	93-13	SHEET NUMBER:	1 OF 1
VERTICAL DATUM:	FURNISHED BY CLIENT		
HORIZONTAL DATUM:	FURNISHED BY CLIENT		

NOTE
THIS MAP COMPLIES WITH NATIONAL STANDARDS FOR MAP ACCURACY IN OPEN, UNOBSTRUCTED AREAS.
IN AREAS OF DENSE VEGETATION AND SHADOWS, WHERE THE GROUND IS OBSERVED FROM VIEW, CONTOURS MAY DEVIATE FROM CORRECT ELEVATION BY ONE HALF THE HEIGHT OF THE COVER.

NOTE
TWO OF THE ORIGINAL CONTROL POINTS WERE OBTAINED BY TREES AND/OR SHADOWS, ANOTHER POINT WAS DESTROYED. PICTURE POINTS WERE REQUESTED OF THE CLIENT, HOWEVER THEY WERE SUPPLIED IN LOCATIONS OFFSET FROM THE AGREED UPON POSITION.
AERO CARTOGRAPHICS HAS EXERCISED GREAT CARE IN ORDER TO MEET NATIONAL MAP ACCURACY STANDARDS, HOWEVER IT IS SUGGESTED THAT CRITICAL AREAS BE FIELD VERIFIED PRIOR TO USE.

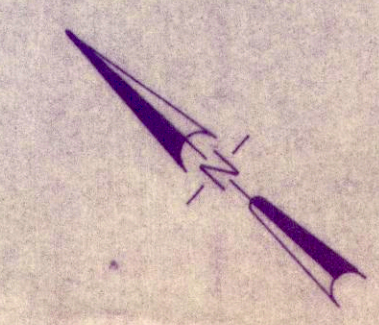

TOPOGRAPHIC MAP OF
SOUTHCOAST DISPOSAL SITE
PREPARED FOR
COUNTY OF MENDOCINO - DPW
340 LAKE MENDOCINO DR.
UKIAH, CA